

QUICK DELIVERY!

Clubhouse
With Pool!



THE ASHTON

21 Candlestick Lane, Sicklerville, NJ 08081

Originally ~~\$206,100~~

You Save **\$3,110!**

Now Priced \$202,990!

- Spacious, 1,720 square foot home
- 3 large bedroom, 1.5 bathrooms
- Spacious open foyer
- Well-designed kitchen with upgraded cabinets
- Walk-out, finished lower-level with powder room and one-car garage!
- Large master suite with walk-in closet
- Full bathroom with double bowl vanity
- Recessed lighting
- Community amenities include: clubhouse, tot lots, jogging trails, swimming pool!
- Convenient to Philadelphia, Atlantic City, Rt. 73, 95 & NJ Turnpike



(856) 728-5656

DECORATED MODELS OPEN MONDAY 1-5 AND
TUESDAY-SUNDAY 10-5, CLOSED WED. & THURS.



Directions from I-295 South or Walt Whitman Bridge/ Ben Franklin Bridge: Take to Route 42 South to Atlantic City Expressway. Take Exit 41(Berlin Cross keys Road). Make a left off of ramp onto Berlin Cross keys Road. At 5th traffic light make a right onto Erial -New Brooklyn Road (RT. 706). Make a left onto Duchess Drive (1st entrance into Wilton's Corner) and another Left onto Kelly Drive. Go straight to Candlestick Lane Models on the Right



ChooseHeritage.com

THE ASHTON

Lower Level

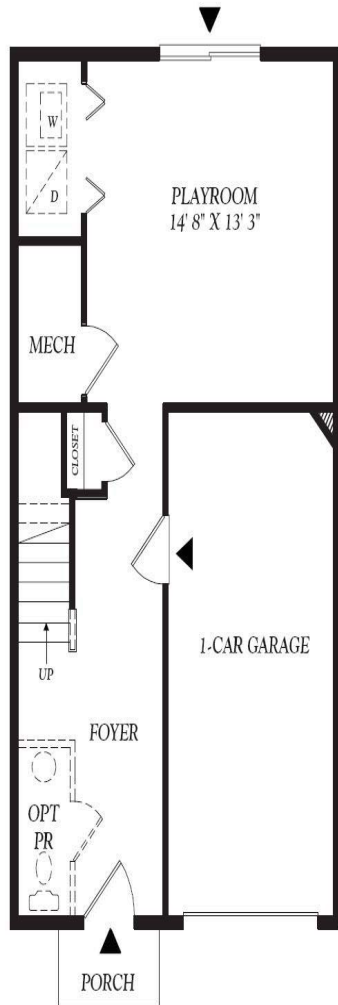

Main Level

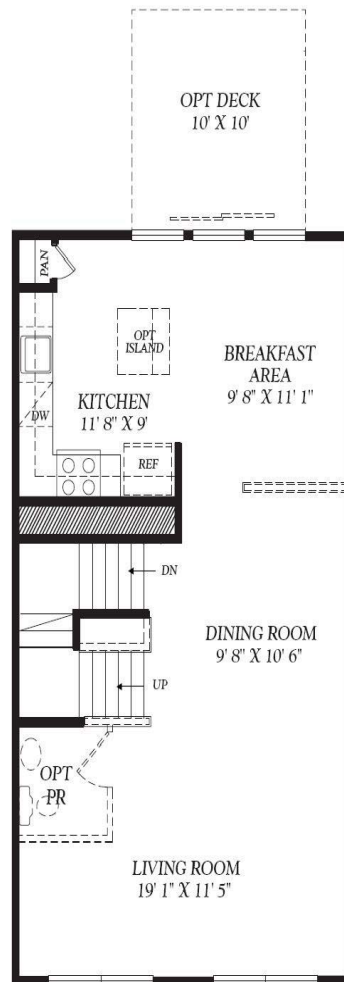

Upper Level

